

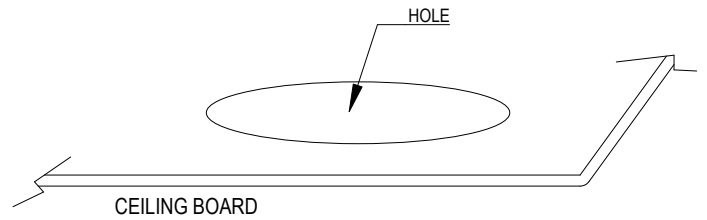

CS510 / 610 / 810 CEILING SPEAKERS INSTALLATION INSTRUCTIONS

STEP 1 : CUT HOLE AT THE CEILING ACCORDING TO THE SPEAKER TYPE

HOLE DIAMETER : 140 MM FOR CS510
185 MM FOR CS610
220 MM FOR CS810



STEP 2 : INSTALL THE SPEAKER ENCLOSURE TO THE HOLE BY SCREWING THE CLAMPS CLOCKWISE THE ENCLOSURE WILL BE TIGHTENED AGAINST THE BOARD

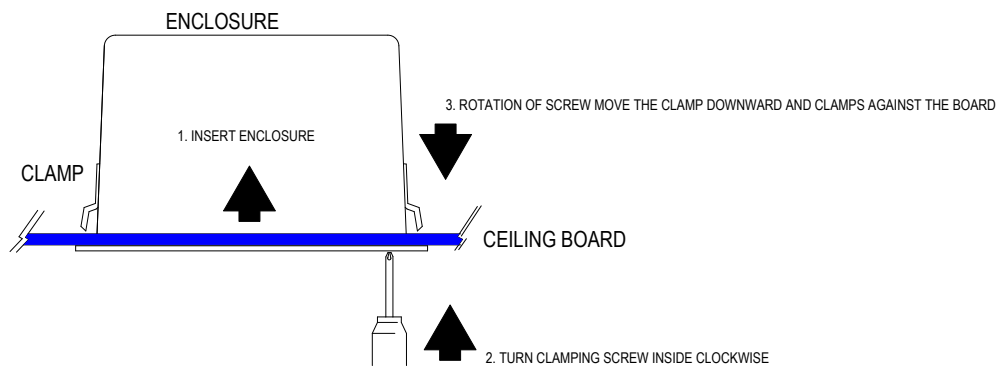

STEP 3 : CABLE TERMINATION

INSERT CABLE VIA ENCLOSURE HOLE AND TERMINATE TO THE SPEAKER ACCORDING TO THE REQUIRED WATTAGE

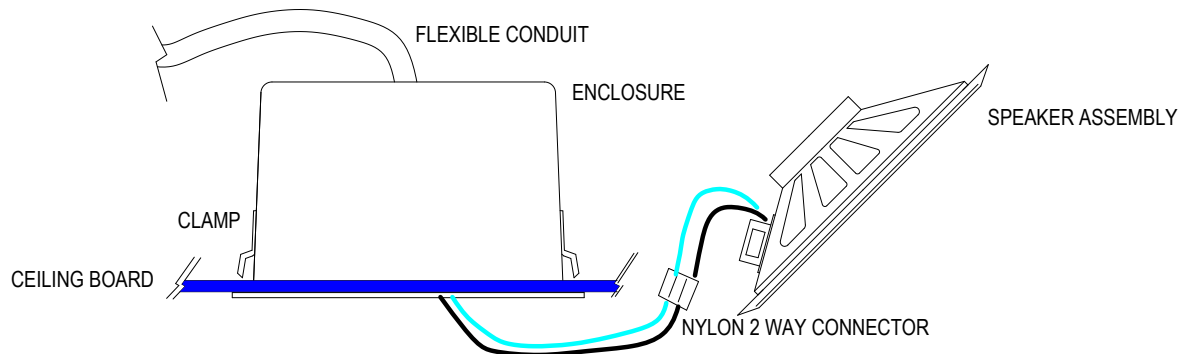

STEP 4 : INSTALL THE SPEAKER AND BAFFLE ASSEMBLY TO THE ENCLOSURE

THE SPEAKER ASSEMBLY WOULD LOCKED TO THE ENCLOSURE TO COMPLETE THE ASSEMBLY PROCESS

